



# LASER ENGRAVING AND CUTTING MACHINE



**APPLICATION**  
Advertising industry  
Leather Industry  
Craft Industry, Model industry  
Packing industry,  
Engrave & Cut in decoration  
industry & electronic appliance  
industry materials

## FEATURES

1. Professional design for client in different industry, reasonable structure, pleased appearance and practical.
2. High strength and high stable mechanical structure composed of high precision mould, machine moved moved stable, in high speed and precision, back open design convenient for material process and no limit for material length.
3. Adopt flight path design, special structure, little path deviation, high performance and easy adjustment.
4. Update flight path design, special structure, little path deviation,

PARAMETER	DG 1309	DG 1325
Working Area	1200x900 mm	2500x1200 mm
Laser type	CO2 Laser EFR / Reci Brand	
Laser Power	60w/80w/100w/130w/150w	
Laser Tube Cooling	Water Cooling Chiller CW5000 / CW 5200	
Laser Output DEPTH	Depend on Laser Power	
Control System	Ruida control system	
Engraving Speed	0-1200mm/s	
Cutting Speed	0-600mm/s	
Vltage	AC220v/110v+-10% 50HZ	
Respositin Accuracy	0.001mm	
Minimum Letter Size	Chinese :1.5 English : 1mm	
Machine Power	1000W	
Moter and Driver	Yako/Leadshine	
Working Enviornment	temperature 0-45C Humidity 5%-95%	



# LASER ENGRAVING & CUTTING MACHINE

**KNTLS**

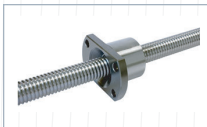

Ball Screw



EFR / Reci / Yongli



Leadshine / Yako

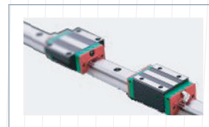

Hiwin

## LASER PRODUCT SAMPLES



World Brand



Wi-Fi



Honors



1 Year Warranty



Swiss Designs

Near SBI Bank Shornur Road, Peringavu  
Thiruvambady (PO) Thrissur - 680 022

**Ph : 99462 79812**